

Angulus 2 – Angled Screwdriver Quick Guide

Set-up

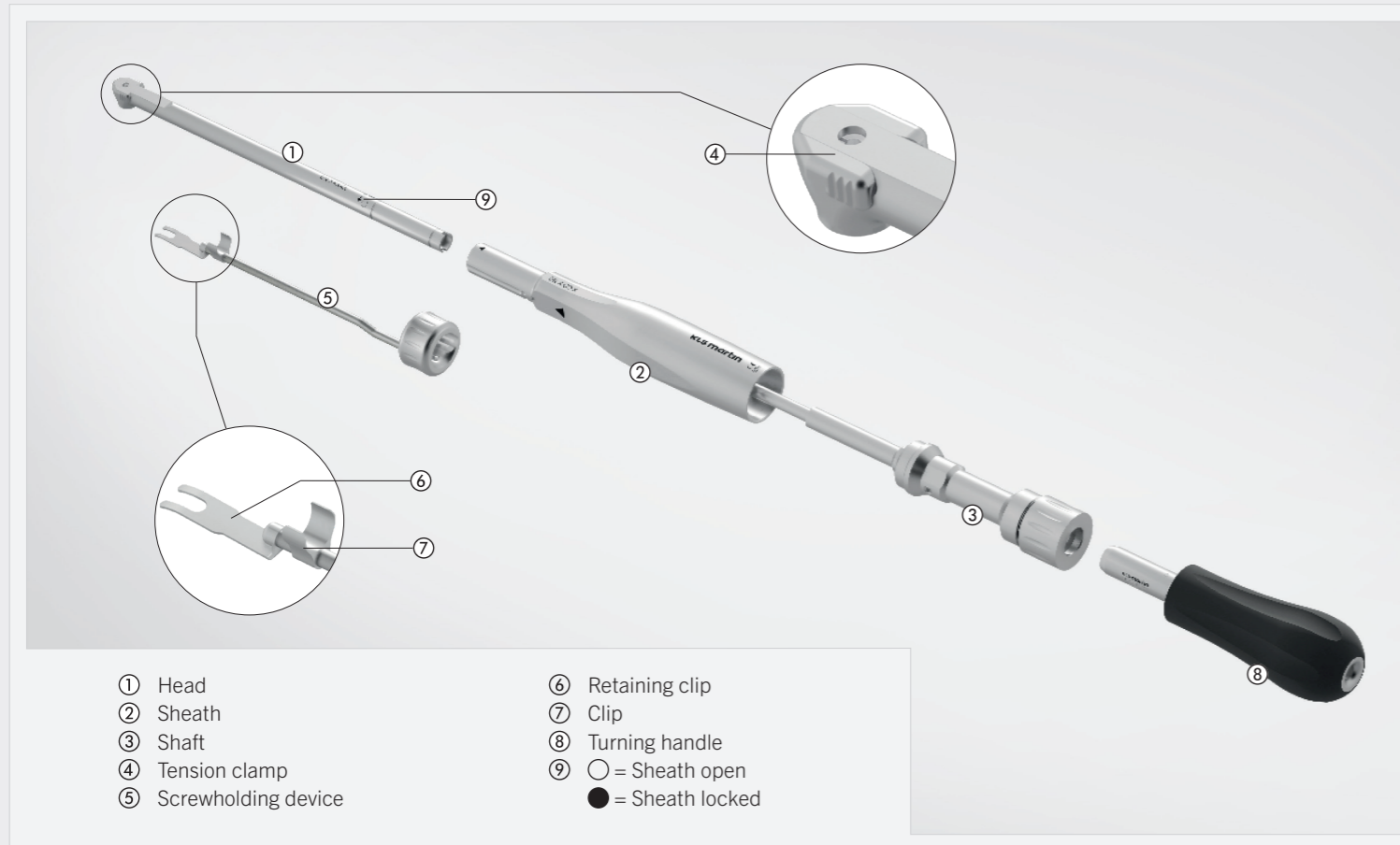

Assembly (disassembly in reverse order)

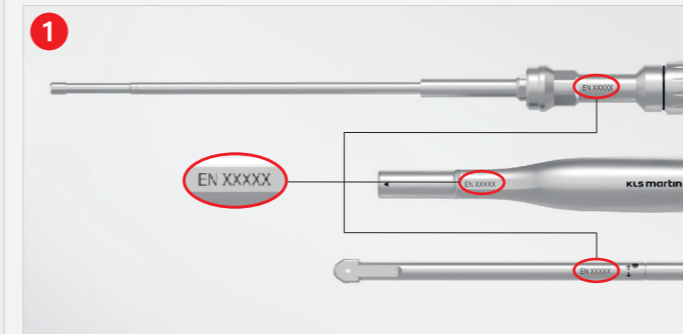

During assembly verify that the EN (serial numbers) of the components match.

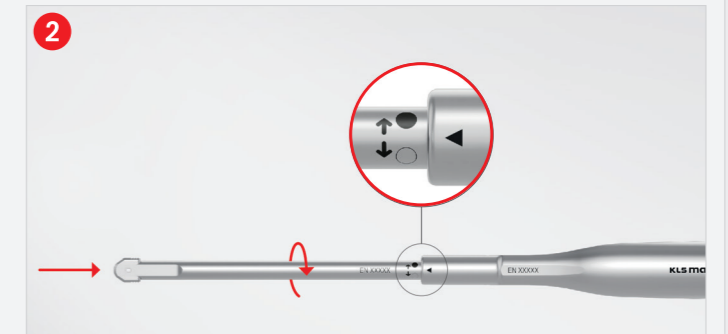

Insert the head into the sheath until it engages. Pay attention to the symbols and turn from ○ to ● until it locks.

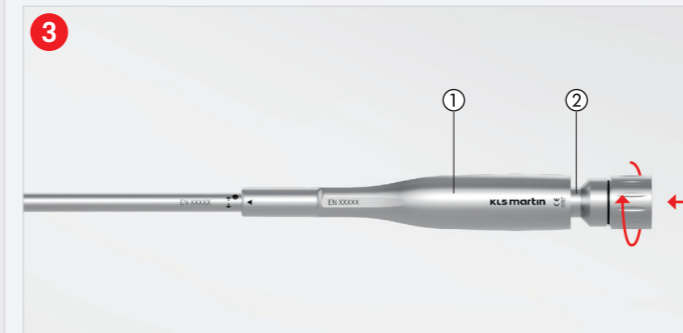

Push the shaft into the sheath and screw this tightly in place.

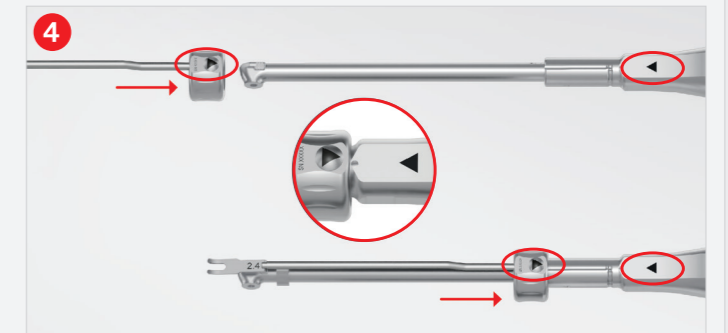

Push the screwholding device until it audibly engages. Pay attention to the positioning and tighten the clip.

Important Note

Never use the Angulus 2 at speeds above 10,000 rpm!

Please obtain further information about the angled screwdriver from the QR codes



Brochure



Video

Maintenance



Only use W&H Service Oil F1 for maintenance. Item number of W&H: 10940021

Storage



For safe storage, we recommend the wire basket (REF 50-990-40-04) and the small storage for accessories (REF 50-990-41-04).